



DATA 2

Self-contained addressable system



PARAMETERS

Max. number of emergency fittings / channel	64
Maximum number of communication channels	4
Maximum number of C-Bridge 2 signal distributor	16
Max. number of emergency fittings in the system	4096

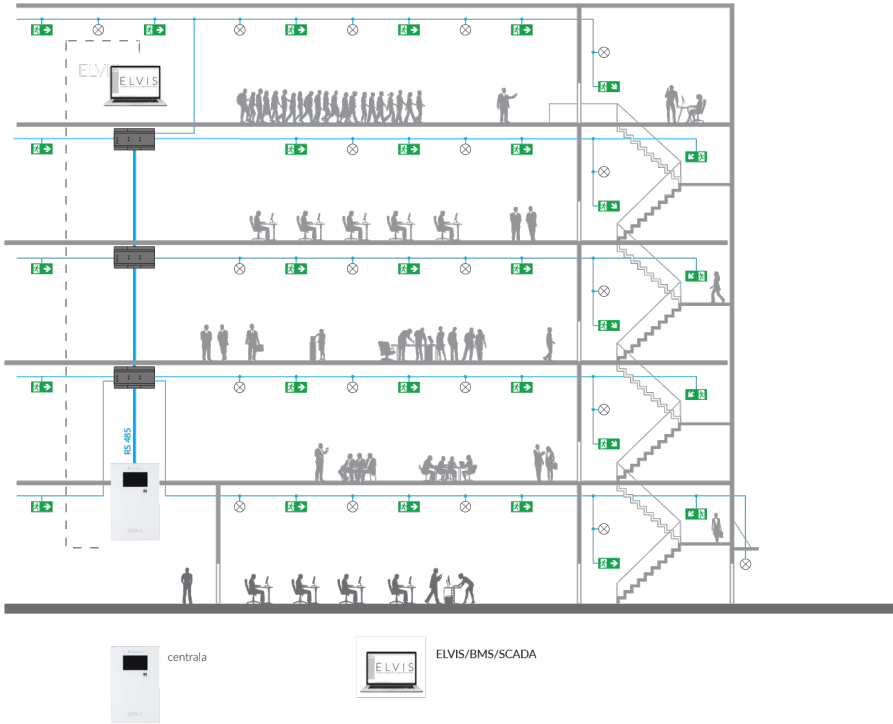

SYSTEM COMPONENTS

CENTRAL STATION



Multifunctional device with touch panel. Controls emergency luminaires. Possibility to download reports on the flash drive and preview the system status through the website.

Material	blacha malowana proszkowo, RAL 9003
Protection degree	IP30
Insulation class	I

I/O MODULE



Device enabling control of emergency lighting groups, dedicated to DATA 2 and TM-CB emergency lighting systems. IN input and OUT output models are available. The DATA 2 and TM-CB system allows the connection of up to 16 I/O modules. The address of each module is set on DiP-switches on their housing. IN SW, IN 24, IN 230 version is used to control the night lighting, fire-emergency lighting groups, fire scenarios and has 8 inputs. The output module (OUT) is used to inform about the system status. It has 8 potential-free outputs.

IN SW	potential-free input
IN 24	24 V voltage detection
IN 230	230 V voltage detection
OUT	potential-free output 400 V AC/ 250 V DC, maks. 6 A

C-BRIDGE 2



Intermediary device for communication between the controller and DATA 2 series addressable devices. The control panel is equipped with one splitter as a standard, but optionally it is possible to connect a second signal splitter, thus increasing the maximum possible number of luminaires to 4096.

C-BRIDGE 2 DATA 2	With battery for mounting in dedicated housings.
C-BRIDGE 2 DATA 2 DIN	With battery for DIN rail mounting in switching stations and shafts.
C-BRIDGE BOX 2	Version built in the C-BRIDGE BOX 2.
Supply voltage	22-25 V DC
Communication speed	RS-485: 19200 bit/s
Bus voltage	15-25 V
Bus communication speed	5 kbit/s
Insulation class	III



WIRING



Communication with controller
Communication with ELVIS, WWW, MODBUS TCP
Communication with addressable devices

RS 485 port

LAN

TM-BUS 2-wire data bus (without polarity) - communication cable
for example: YTKSYekw 1 x 2 x 0.8 mm² or other wires complying with the parameters:
length: max. up to 1,000 m
operating temperature: -15°C to + 70°C
resistance: max. 75 Ω/km
conductor capacity: max. 120 nF/km

*ELVIS

Emergency Lighting Visualization System

An additional facilitation in the management of emergency lighting luminaires is the software that visualizes the arrangement of luminaires on the actual plan of the building. It enables remote management and testing of emergency lighting fittings, as well as generating and downloading reports required by law.

*optional element of the system

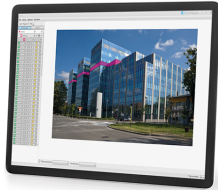

*TM-PROG RFID

TM-PROG RFID is a programming device used to read and addresses of lighting fittings that are compliant with TM-CB A or DATA 2 /DATA 2 EASY system.

- » Programming is executed in a wireless mode that provides for operation without connecting lighting fittings to a power supply.
- » The programming device has a built-in battery that offers long operating time, and the current consumption is shown on a display.
- » The programming device has an ergonomic casing that protects the device against mechanical damage and prevents accidental slipping from the hand.

*optional element of the system

